

The logo features a stylized building icon on the left, composed of vertical gold lines of varying heights. To the right, the word 'ELEVEN' is written in a large, bold, black sans-serif font. Below it, 'BRINDLEYPLACE' is written in a smaller, black sans-serif font. At the bottom, 'BUSINESS CENTRE' is written in white, uppercase letters inside a horizontal gold bar.

ELEVEN BRINDLEYPLACE BUSINESS CENTRE

Serviced office suites for 2 - 300 people



Stylish | Contemporary | Prominent

Centrally located in Birmingham's thriving core.

VIBRANT WORK ENVIRONMENT

- Serviced office suites ready for immediate occupation in this impressive building set within an outstanding established business destination in the heart of Birmingham.
- Newly renovated communal spaces offer a relaxed and inspiring environment, offices benefit from excellent natural light levels with floor to ceiling glazing and there are a variety of on-site meeting rooms.
- Fully-inclusive packages provide you with all you need to start work with flexible contract terms and options to expand or contract.



INDICATIVE FLOOR PLAN

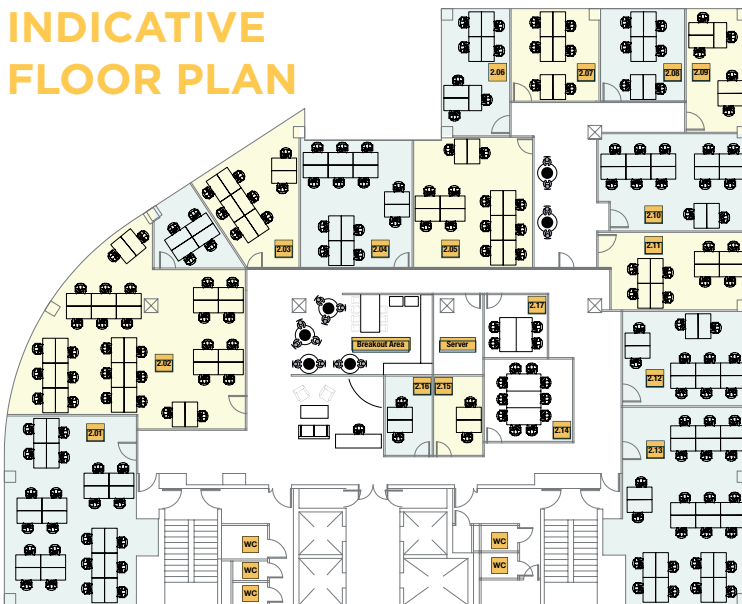

THE SIMPLE SOLUTION TO MEET ALL YOUR OFFICE NEEDS

Our fully-inclusive packages provide you with the following:

- | | |
|--------------------------------------|---|
| • High quality fit-out | • Statutory compliance |
| • Furniture | • High speed passenger lifts |
| • Concierge & staffed main reception | • Bookable meeting rooms |
| • High speed internet | • Bicycle storage facilities |
| • Dedicated bandwidth options | • Shower facilities |
| • VOIP phone system | • Mail services |
| • Business lounge & tea point | • Business rates |
| • Floor to ceiling glazing | • Service charges |
| • 24/7 secure access | • Maintenance |
| • Building services | • Utilities |
| | • Building & landlords contents insurance |

LOCATION

- Prestigious canalside position at the heart of the city with easy access to an unrivalled array of eateries, shops, galleries, health clubs, hotels and attractions.
- A short walk from New Street Station.
- Easy access to the M5, M6 and M42 via the Aston Expressway A38(M), as well as to the M1, M40 and M54 motorways.
- Tram stops (now fully operational) are a short walk from the business centre, providing easy access to New Street and Snow Hill railway stations.